

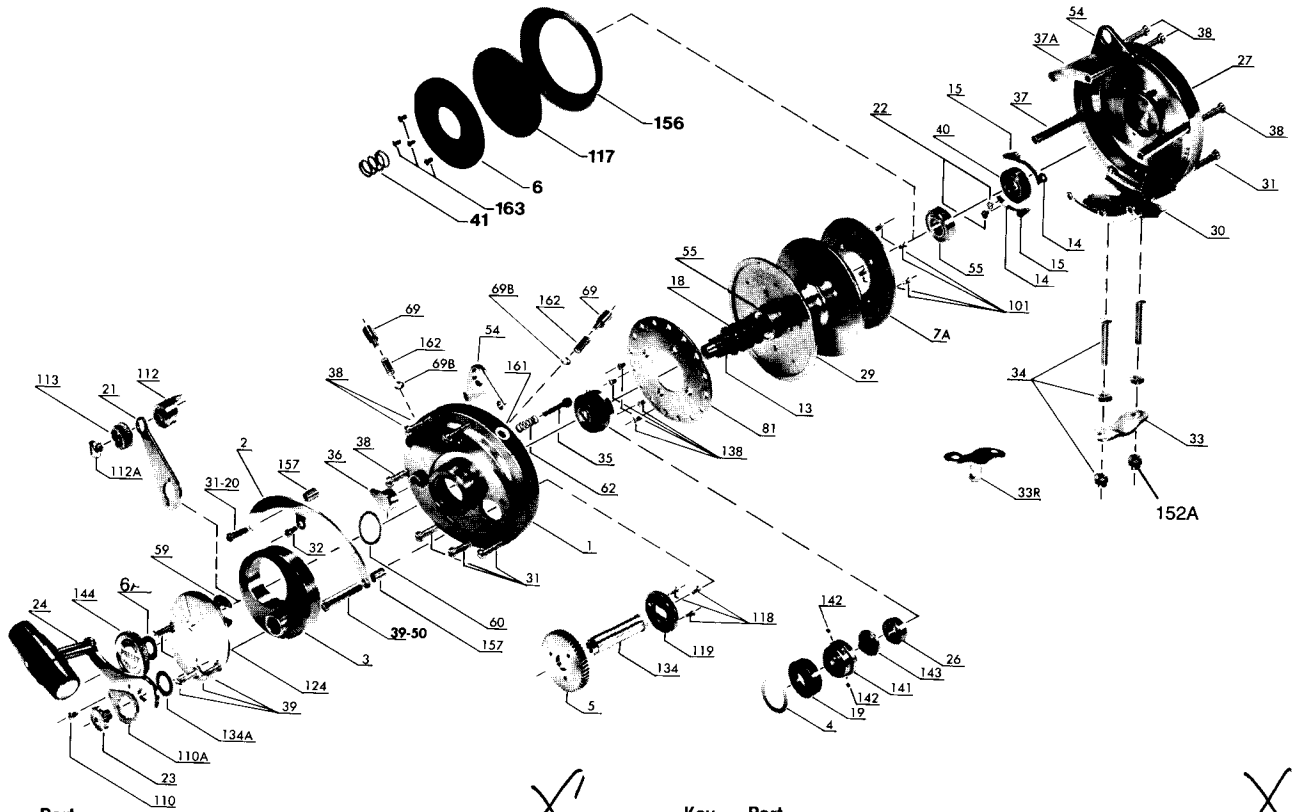

PARTS AND PRICE LIST FOR INTERNATIONAL 20 AND 30



Key No.	Part No.	Description	Price
1	1-20	Right Side Plate Assembly	\$59.50
	1-30	Right Side Plate Assembly	59.50
2	2-30	Quadrant Ring	4.80
3	3-30	Bridge	10.60
4	4-30	Cam Thrust Washer	.80
5	5-50	Main Gear	9.10
6	6-30	Drag Washer	9.25
6A	6-155	Spacer Washer	.50
7A	7A-30	Metal Drag Washer	6.20
9	9-30	Spacing Sleeve (N/S)	.60
13	13-20	Pinion Gear	17.20
	13-30	Pinion Gear	18.55
14	14-50	Dog Spring	.45
15	15-50	Dog	.70
18	18-20	Disc Clutch Spring Model #20	.60
	18-30	Disc Clutch Spring Model #30	.60
18A	95A-20	Click Bushing Washer	.50
19	19-30	Eccentric Cam	5.70
21	21-30	Eccentric Cam Lever	4.80
22	22-109	Dog Spring Screw	.45
23	23-114	Handle Screw	2.25
24	24-30	Handle	10.60
26	20-704	Right Side Bearing	14.00
27	27-20	Left Side Plate	49.50
	27-30	Left Side Plate	49.50
29	29L-20	Spool	58.25
	29L-30	Spool	63.50
30	30-20	Stand	8.25
	30-30	Stand	8.75
31	31-20	Stand Screw (6)	.40
31-20	31-20	Quadrant Screw	.40
32	32-14	Center Quadrant Screw	.35
33	33-49	Rod Clamp Model 20	1.90
	33-200	Rod Clamp Model 30	3.25
*33R	33R-49	Ringed Rod Clamp Model 20	4.30
	33R-200	Ringed Rod Clamp Model 30	4.80
34	34-20	Rod Clamp Screw w/Nuts (#20)	1.45
	34-30	Rod Clamp Screw w/Nuts (#30)	1.45
35	35-50	Click Tongue	.90
36	36-50	Click Button	2.00
36A	36-700	Click Button Nut	.70
37	37-20	Frame Post	1.35
	37-30	Frame Post	1.55

Key No.	Part No.	Description	Price
37A	37A-20	Spacer Bar	\$ 9.15
	37A-30	Spacer Bar	9.50
38	38-50	Post Screws (7)	.45
39	39-12	Bridge Screws (3)	.45
39-50	39-50	Special Post Screw	.85
40	55-80	Left Side Bearing	18.00
41	41-50	Left Side Bearing Spring	.70
54	54-50	Harness Lugs (2)	2.15
55	20-704	Spool Bearings (2)	14.00
59	59-50	Slotted Washer	.70
60	60-50	Backing Washer	.70
62	62-50	Click Spring	.70
69	69-50	Locating Pin	.95
69B	69B-50	Retaining Ring	.70
81	81-50	Ratchet	4.40
95	95-50	Click Tongue Bushing (N/S)	1.55
95B	38-710	Click Bushing Nut (N/S)	.45
101	101-30	Metal Drag Washer Screws (4)	.40
110	110-50	Handle Lock Screw	.45
110A	110A-50	Handle Locking Plate	1.05
112	112-50	Eccentric Lever Knob	13.95
112A	112A-50	Eccentric Knob Screw	.75
113	113-50	Eccentric Lever Cap	4.20
117	117-30	Drive Plate	15.90
118	38-7	Main Gear Plate Screws (3)	.35
119	119-50	Main Gear Plate	.95
124	124-30	Bridge Cover	4.40
134	134-50	Gear Stud	4.80
134A	134A-50	Gear Stud Washer	.75
138	101-30	Ratchet Screws (4)	.40
141	141-30	Cam Follower	4.80
142	142-50	Cam Follower Pins (2)	.45
143	143-30	Adjusting Screw	1.95
144	144-50	Pre-Set Knob	5.90
149	149-200	Rod Clamp Hex Nut	.40
152A	152A-50	Rod Clamp Acorn Nut	.70
156	156-30	Drag Cover	3.75
157	157-50	Quadrant Spacer Bushings (2)	.45
161	161-50	Locating Pin Bushing	.95
162	162-30	Locating Pin Spring	.40
163	101-30	Drive Plate Screw (4)	.40

* Not Shown